

SECTION A

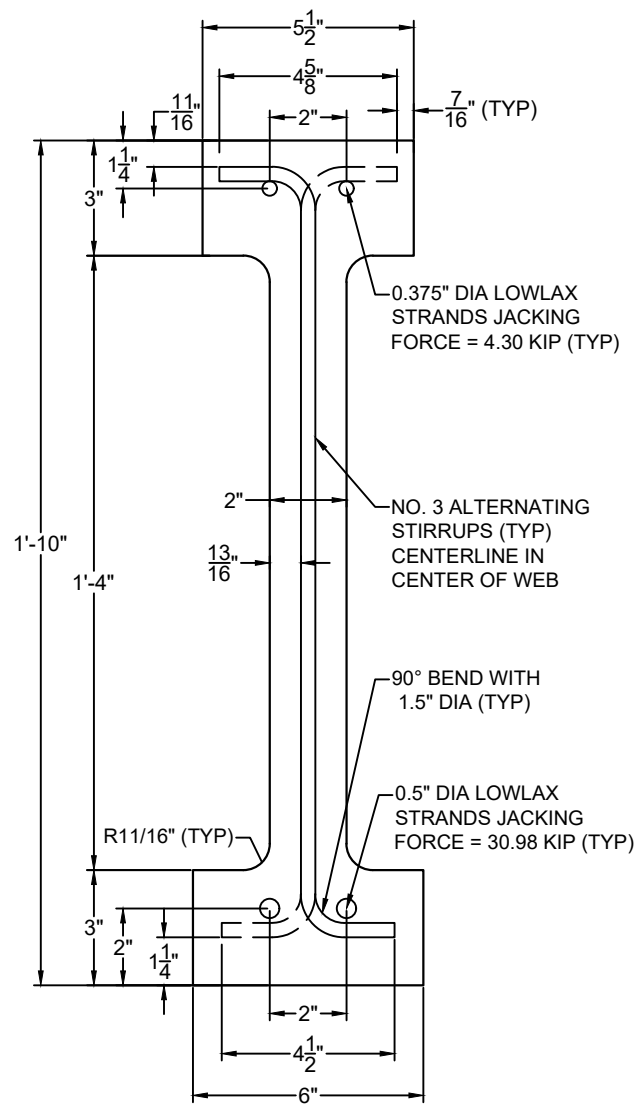

SCALE: 1" = 5"

BILL OF MATERIALS

ITEM	QTY	UNIT	COMMENTS/CRITERIA
0.375" DIA. LOWLAX STRAND, 18'	2	EA	ASTM 615
0.5" DIA. LOWLAX STRAND, 18'	2	EA	ASTM 615
NO. 3 REBAR S-SHAPE STIRRUPS	29	EA	ALTERNATING ORIENTATION
TPAC LW-5 MIX CONCRETE	0.315	CY	ASTM C150 FLY ASH CONFORMS TO C618 INITIAL STRENGTH = 5 KSI 28 DAY STRENGTH = 8 KSI
4" X 8" TESTING CYLINDERS	15	EA	ASTM C31
0.5" STRAND LIFTING LOOP	2	EA	EXTRA 0.5" LOOP TO MARK 6.25" STIRRUP SPACING SIDE

TOTAL BEAM WEIGHT

1080	LBS
------	-----

PROFILE

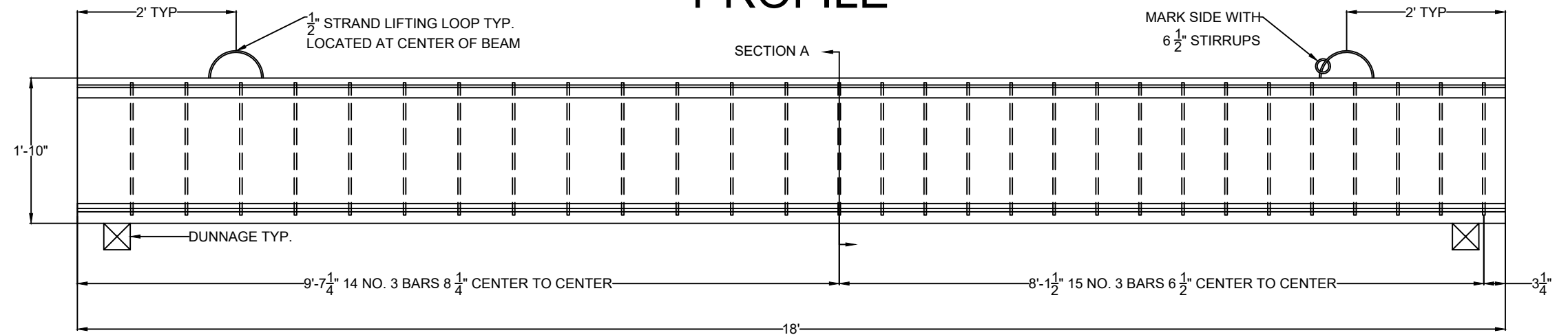

SCALE: 1" = 20"

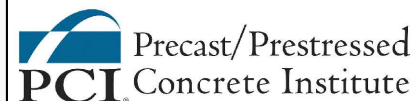
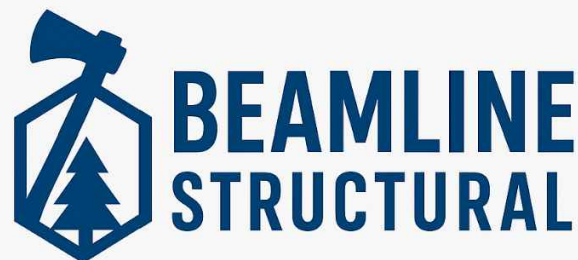

2025-2026 PCI BIG BEAM COMPETITION SHOP DRAWING

DATE: 03/17/2026

DRAWN BY: LP/JS/KC/DM

REVISION: 2



Steve Sanghi College of Engineering
NORTHERN ARIZONA UNIVERSITY
2112 S HUFFER LANE FLAGSTAFF, ARIZONA 86011

PAGE: 1

OF: 1